

Subject: <b>Two-Inch Scaleplate Insertion Instructions</b>	Initial Release Date: 02/95	Revision Date: 04/15/97	Revision: A
	Product Group: Heavy Duty		Page: 1 of 2

## 1. Introduction

This Product Information Note describes how to replace the scaleplate on 2-inch gauges.

## 2. General Information

Two-inch gauges are identical in design and hardware with the exception of their scaleplates. Installing a scaleplate automatically programs a gauge to the function represented by that scaleplate.

**Note:** Store and hold gauges in their normal operating position or face up to prevent the gauge dampening fluid from leaking out. Do not leave gauges face down longer than 15 minutes.

## 3. Procedure (See Figures 1 and 2)

To disassemble a 2-inch gauge:

1. Turn the bezel counter-clockwise about 1/4 turn and remove the bezel, glass, gasket and mask ring. This requires a fair amount of force.
2. Gently slide the gauge out of the housing.
3. Gently pull the tail of the scaleplate out from under the connector on the printed circuit board.
4. Remove the scaleplate by allowing the gauge pointer to pass through the cut on the scaleplate.

To reassemble a 2-inch gauge:

1. Attach the scaleplate to the gauge as shown in Figure 2.
2. Insert the gauge into the housing, ensuring the connector extends through the rear of the housing. The three round notches in the printed circuit board fit over the round guides on the inside of the housing. The gauge is correctly inserted when the two round notches in the front of the gauge fit over the two round guides on the inside of the housing and the connector extends slightly out the rear of the housing.
3. Hold the gauge and housing face up. Line up the hole in the finger of the mask ring over the LED in the gauge and place the mask ring down over the scaleplate. When the mask ring is correctly installed, the two round notches on the outside will mate with the two guides on the inside of the housing.
4. Center the gasket over the mask ring.
5. Center the glass faceplate over the gasket.

Subject: <b>Two-Inch Scaleplate Insertion Instructions</b>	Initial Release Date: 02/95	Revision Date: 04/15/97	Revision: A
	Product Group: Heavy Duty		Page: 2 of 2

6. Line up the tab on the back of the bezel with the cut-out in the housing, then twist the bezel 1/4 turn clockwise until it clicks into place.

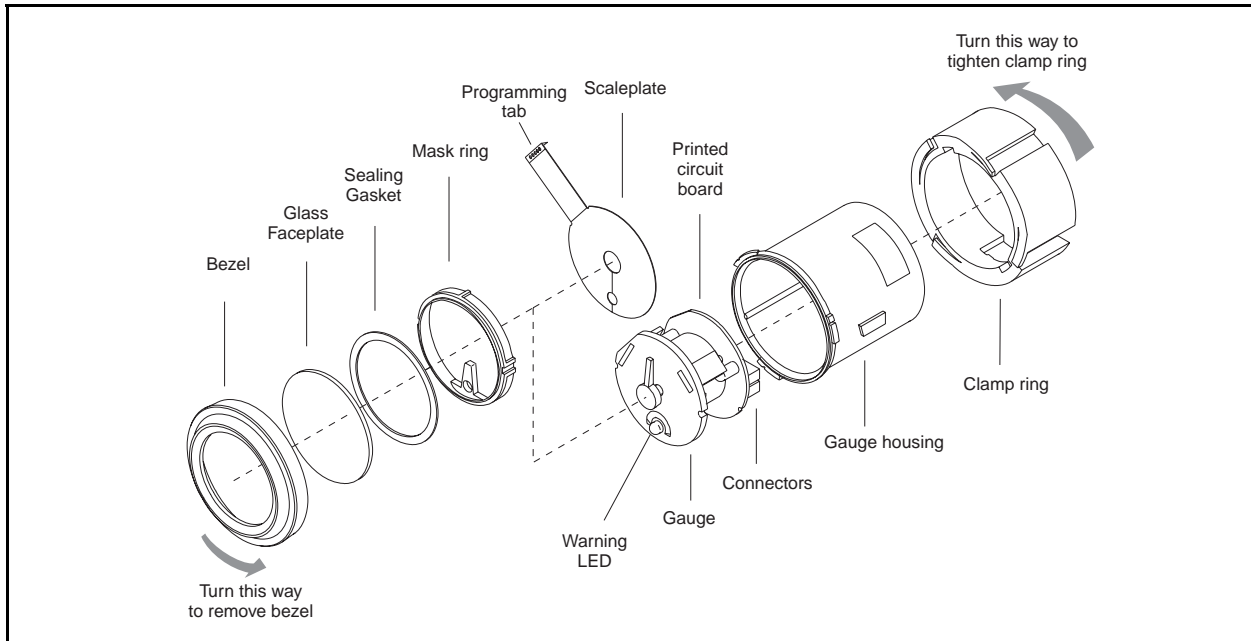

**Figure 1** Exploded view of a 2-inch gauge

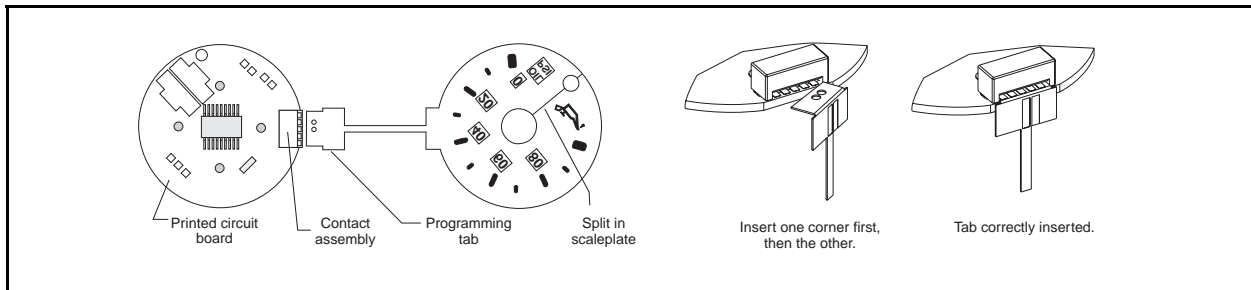

**Figure 2** Correctly aligning the programming tab into the scaleplate

#### 4. Technical Support

Technical Support assistance is available by calling the Customer Service Department at (970) 244-1243. The hours are Monday through Thursday from 7:00 a.m. to 5:30 p.m. MST, and Friday from 7:00 a.m. to 3:30 p.m.